



WINDOW TECHNOLOGY
DOOR TECHNOLOGY
AUTOMATIC ENTRANCE SYSTEMS
BUILDING MANAGEMENT SYSTEMS



DOOR TECHNOLOGY – ORDER CATALOGUE

Door hinges for PVC main, apartment and secondary entrance doors

Edition 03/2014

- Door hinges for elements weighing up to 160 kg
- Door hinges for elements with slim profiles

Securing technology for you



Stability and security in one flexible system

Door hinges of the Gretsch-Unitas Group



Commitment to tradition – setting the highest design and quality standards

Gretsch-Unitas Group

The owner-operated GU Group has been setting standards since 1907 with hardware solutions. The highest maxim in any product development is being able to see the bigger picture. We test how each detail interacts with functional, architectural, ecological, manufacturing and process-specific requirements – our **high-quality products** meet these expectations.

Tested quality

Products by Gretsch-Unitas for opening and closing windows and doors have been held in high regard for more than 100 years throughout the world thanks to the tried-and-tested quality and level of security they offer. Fully-fledged technology for system solutions tailored to individual requirements is just one the strengths of this long-established company.

Know-how from the experts

The **diversity** and flexible compatibility of all products in the group make it possible for architects to deliver **high-quality compatible products** and **design lines** for projects. The competence to be able to cover everything makes us **unique in the market**.



General information

Overview of features	04 –05
Overview of standards – classification code in accordance with EN 1935	06 –07
Door hinges suitable for use in escape and rescue routes	08
The Construction Products Regulation	09
Useful information – Installation recommendation; opening directions	10
Product-specific accessories	11

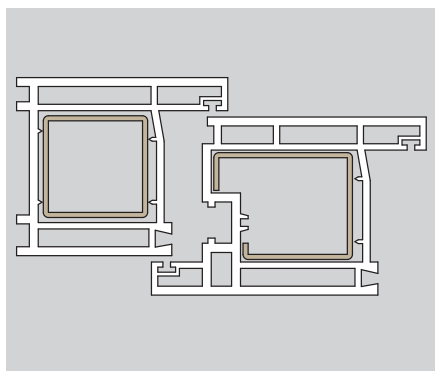

Door hinges for main, apartment and secondary entrance doors

GU G 816 F 100	for doors up to 160 kg	12-13
GU G 812 F 100	for doors up to 120 kg	14-15
GU G 810 F 100	for doors up to 100 kg	16-17

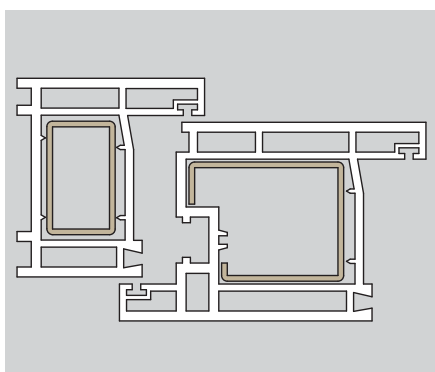

Door hinges for main, apartment and secondary entrance doors with slim and especially slim profiles

GU G 810 F 85	for doors up to 100 kg	18-19
GU G 810 F 100 S	for doors up to 100 kg, for especially slim profiles	20-21
GU G 810 F 85 S	for doors up to 100 kg, for especially slim profiles	22-23
GU F 110	for doors up to 100 kg	24-25
GU F 90	for doors up to 80 kg	26-27



GU door hinges

Recommendations for profile-specific recommendations	28-31
3D adjustment options	32
Exclusion of liability	33
The GU Group worldwide	34
Successfully certified	35

Overview of features





Gretsch-Unitas door hinges can be used with PVC doors in virtually every installation situation. The screw-on hinges are easy to handle during installation and can also be adjusted in 3 directions once installed without unfastening the fixing screws. Furthermore, with outwards opening elements the cover caps can be secured from the inside. The range is supplemented by suitable drilling jigs. In addition, all door hinges are DIN RH and DIN LH usable.

This not only saves valuable time and resources, it also guarantees that the work process goes smoothly right up until the door installation is complete.

Hinges for different overlap heights can easily be adapted to the corresponding profile system. Doors with a leaf weight of up to 160 kg can thus be safely installed.

All hinge components are manufactured from aluminium with corrosion-resistant steel pins. The high-quality PVC maintenance-free bearing also guarantees long-term functional reliability.

The Gretsch-Unitas group offers everything that ensures the smooth and trouble-free interplay between functional components: a broad selection of products, technical innovations, excellent quality and comprehensive services. This also of course includes competent, technical advice. Installation drawings are available for all door hinges with special profile combinations and the individual installation situations, also for doors in escape and rescue routes – simply get in touch with us!

Standards at a glance

Classification code in accordance with EN 1935



Use of the most advanced technologies and the great innovative strengths of Gretsched-Unitas achieves optimum results by always being one step ahead of the standards when it comes to quality, safety and durability.

In addition to increasing internationalisation of these requirements, which are, for example, reflected in European standards and regulations, the everyday demands for convenience, traffic, burglar inhibition, fire protection, etc. must also be taken into account.

Admittedly, this is not always easy.

With our innovative and modern product systems, we offer you maximum planning security. Our unique functional and design characteristics also give you a high degree of design freedom.

We have collected the most important standards and regulations on the following pages.

Classification code EN 1935

EN 1935 defines the requirements and test methods for single-axis door and window hinges and documents these in a so-called classification code. The eight numbers of the code stand for:

First number	Second number	Third number	Fourth number	Fifth number	Sixth number	Seventh number	Eighth number
Class of use	Operational reliability	Door dimensions	Suitability for fire and smoke protection doors	Security	Corrosion resistance	Burglar resistance	Hinge class

The hinge class for which the door hinges in this order catalogue have been approved is indicated by the  symbol.

EN 1935

The classification code is compiled as follows:

First number = class of use

Class 1: light use

Hinges for doors or windows with a low frequency of use by persons with an interest in exercising great care and where a low risk of incorrect use exists, e.g. in residential buildings or buildings that are not accessible to the public.

Class 2: medium use

Hinges for doors or windows with a medium frequency of use by persons with an interest in exercising due care but where a certain risk of incorrect use exists, e.g. in buildings with limited public access.

Class 3: heavy use

Hinges for doors or windows that are frequently used by the public or persons with a low interest in exercising due care and where a high risk of incorrect use exists, e.g. in public buildings.

Class 4: extremely heavy use (classes 12, 13, 14)

Hinges for doors or windows exposed to use of force or material damage. Hinges in class 12 are exposed to a risk of deliberate misuse. Hinges in the classes 13 and 14 offer increased resistance to potentially sustained heavy assault.

Second number = operational reliability

Window hinges are classified as follows:

Class 3: 10,000 cycles

Class 4: 25,000 cycles

Door hinges are classified as follows:

Class 4: 25,000 cycles

Class 7: 200,000 cycles

Third number = door dimensions

Class 0: up to 10 kg

Class 1: up to 20 kg

Class 2: up to 40 kg

Class 3: up to 60 kg

Class 4: up to 80 kg

Class 5: up to 100 kg

Class 6: up to 120 kg

Class 7: up to 160 kg

Fourth number = suitable for fire and smoke protection doors

Class 0: not suitable for fire/smoke protection doors

Class 1: suitable for fire/smoke protection doors

Fifth number = security

The standard requires a basic level of user safety for all hinges.

Class 1 has therefore been defined.

Sixth number = corrosion resistance

Class 0: corrosion resistance not defined

Class 1: low corrosion resistance

Class 2: medium corrosion resistance

Class 3: high corrosion resistance

Class 4: extremely high corrosion resistance

Seventh number = burglar resistance

Class 0: no burglar inhibition

Class 1: burglar-inhibiting, depending on assessment of contribution made by the hinges to burglar inhibition.

Eighth number = hinge class

The hinge class is determined based on the characteristics tested under numbers 1-7. The following matrix shows which class must be achieved for each of the test steps and the resulting hinge class.

Classes achieved in the testing of numbers 1-7.							Hinge class
1	2	3	4	5	6	7	
1	3	0	0 / 1	1	0 - 4	0 / 1	1
1	3	1	0 / 1	1	0 - 4	0 / 1	2
1	4	1	0 / 1	1	0 - 4	0 / 1	3
2	7	1	0 / 1	1	0 - 4	0 / 1	4
1	3	2	0 / 1	1	0 - 4	0 / 1	5
1	4	2	0 / 1	1	0 - 4	0 / 1	6
2	7	2	0 / 1	1	0 - 4	0 / 1	7
1	3	3	0 / 1	1	0 - 4	0 / 1	8
1	4	3	0 / 1	1	0 - 4	0 / 1	9
2	7	3	0 / 1	1	0 - 4	0 / 1	10
3	7	4	0 / 1	1	0 - 4	0 / 1	11
4	7	5	0 / 1	1	0 - 4	0 / 1	12
4	7	6	0 / 1	1	0 - 4	0 / 1	13
4	7	7	0 / 1	1	0 - 4	0 / 1	14

In addition to carrying the CE marking, hinges used in the Netherlands must also be SKG-certified.

The hinges in this catalogue labelled with  are SKG-certified in the Netherlands.

On the safe side with GU Group products

Door hinges suitable for use in escape and rescue routes



CE-compliant products from the GU Group range for:

- ① = Emergency exit and panic exit devices
- ② = Mechanical/electromechanical locking systems
- ③–⑥ = Door closers, hold-open systems
- ⑦ = Fire alarm systems, smoke detectors
- ⑧ = Door and window hinges
- ⑨ = Accessories



All door hinges in this order catalogue tested to EN 1935 and therefore approved for use on escape and rescue doors are identified by the  symbol.

The following harmonised standards are applied to Gretsch-Unitas Group products

DIN	Description
EN 179	① Emergency exit devices (in escape routes)
EN 1125	① Panic exit devices (in escape routes)
EN 14846	② Electromechanical locks and strikers (in fire-retardant doors)
EN 12209	② Mechanical locks and strikers (in fire protection doors)
EN 1154	③ Door closers (in fire protection doors)
EN 1158	④ Door coordinator devices (in fire protection doors)
EN 1155	⑤ Electrical dogging mechanisms in swing doors (in fire protection doors)
EN 14637	⑥ Electrically controlled hold-open systems (for fire and smoke protection doors)
EN 54-7	⑦ Fire alarm systems – (Part 7: smoke detectors)
EN 1935	⑧ Uniaxial door and window hinges (in escape routes and/or fire-retardant doors)
EN 14967	⑨ Sealing sheets – bitumen damp-proof sheets
EN 12101-2	Smoke & heat control systems

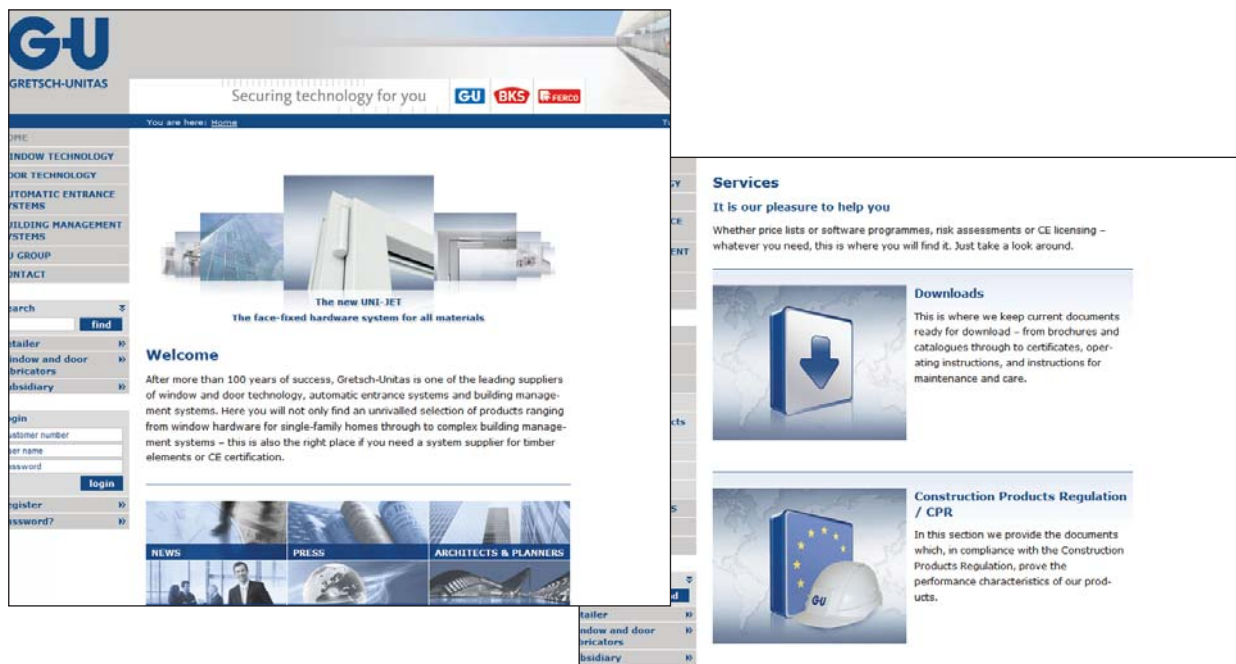

By attaching the CE marking, the manufacturer confirms that the product fulfils all conditions prescribed by law for the CE marking. This confirms that the manufacturer takes responsibility for compliance of the construction product with the characteristics listed in the Declaration of Performance.

"CE marking is the technical passport for the product within the European Economic Area."
(Deutsches Institut für Normung e. V., the German institute for standardisation)

The Construction Products Regulation regulates the application of standards, production documentation as well as marking and monitoring. Under these conditions, CE marking is performed for the construction products which guarantees that the manufacturers comply with the valid specifications.

In the process, this marking and documentation must not only be applied to a complete system, such as a door or window. Components (e.g. hinges) that are subject to a harmonised standard must also carry a CE marking.

On our website:

www.g-u.com/service/bauproduktenverordnung.html

you can download certificates and **Declarations of Performance (DoPs)** for our products. In addition to Declarations of Performance, you can also find complementary documents such as the Environmental Product Declaration and clearance certificates in accordance with the REACH regulation

Useful information

Installation recommendation; opening directions



Door types

Many different door types can be used in a building.

Apartment entrance doors, e.g. in the stairwell, protect the private zone. PVC doors weighing 50-80 kg are normally used for this.

In many cases, outer doors or secondary entrance doors are only seldom used. To preserve the design of the building, only slender PVC profiles are frequently used for doors up to 100 kg.

Main entrance doors made of PVC must guarantee a high level of security and are frequently used, these are normally heavy doors weighing up to 160 kg.

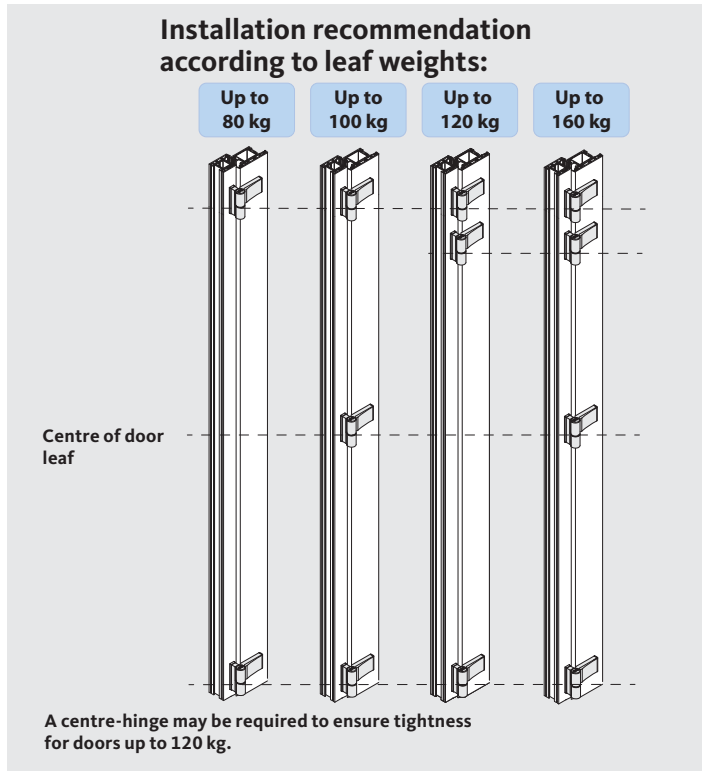

Opening directions / Side of hinges

The hinge side is the side on which the door leaf connects to the door frame. If the hinges are on the left when viewing the door from the side on which the hinges are visible, the door is referred to as a DIN LH door. If the hinges are on the right, the door is referred to as DIN RH door.

DIN right

Door hinges on right

Lever handle pointing to the right

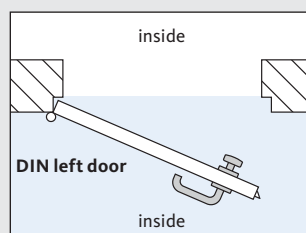
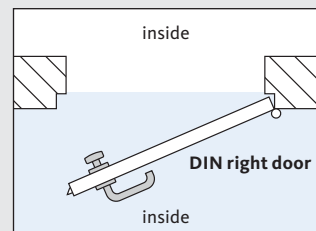

DIN left

Door hinges on left

Lever handle pointing to the left

Drilling jig and drilling jig holder

To ensure fast and problem-free installation, you can obtain the necessary accessory items, e.g. drilling jigs and drilling jig holders, for all door hinges. You can find the corresponding order number on the order page for the relevant hinges.

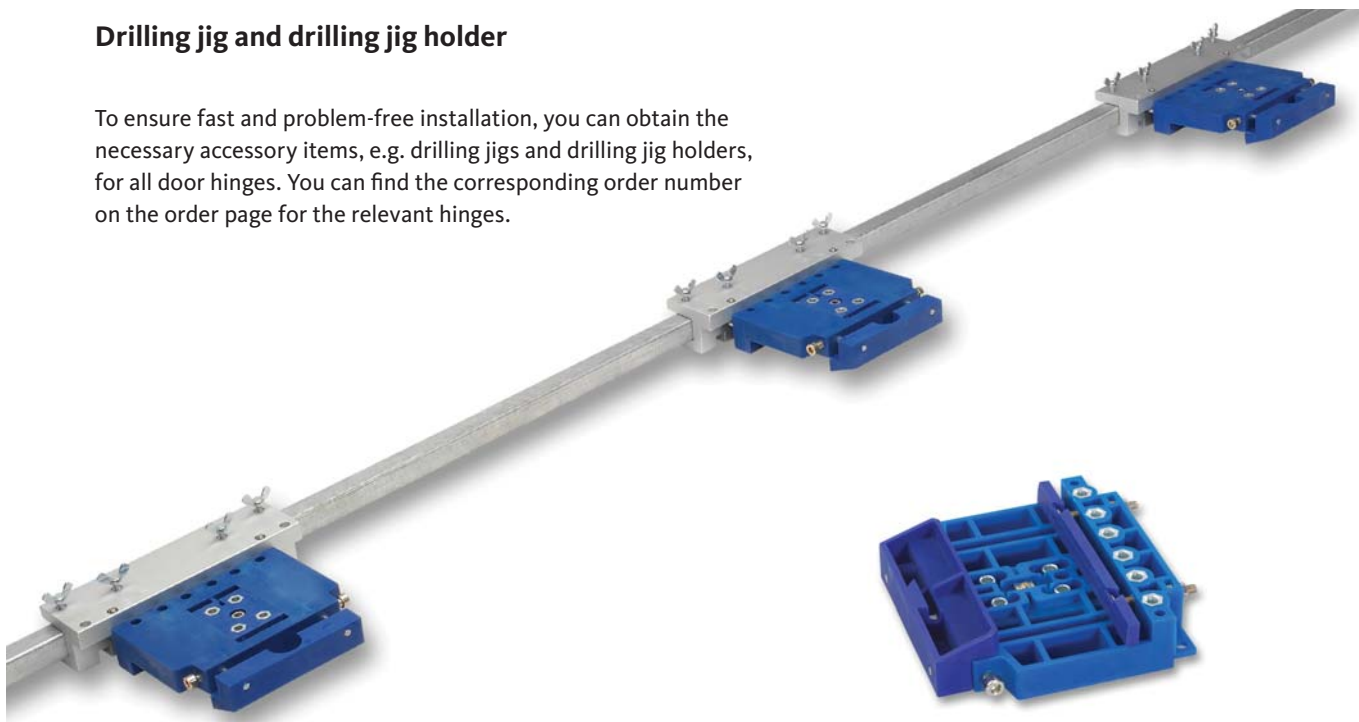

Security set for external installation

- 1 Simply tap the security pin into the open screw head.
- 2 Break off the shaft of the security pin.
- 3 The head of the security pin remains in the screw head and can no longer be detached using an assembly tool.



GU G 816 F 100

For elements up to 160 kg, 100 mm leaf part



Product information

- Simple service-friendly one-man-installation
- 3D adjustment using only one tool, no need to unhinge or support the door leaf
- Simple installation requiring only 1 drill bit size
- Linear horizontal adjustment
- Non-corrosive security adjustment pin as standard

Materials

- Aluminium frame and leaf part
- Stainless steel pins
- Maintenance-free bearing system

Version

- Non-handed, exterior and interior use
- 100 mm leaf part

Overlaps

- 13.5 to 19.5 mm
- 17 to 23 mm
- 22 to 28 mm

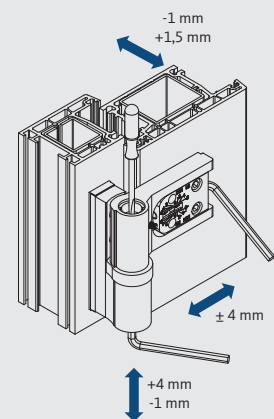
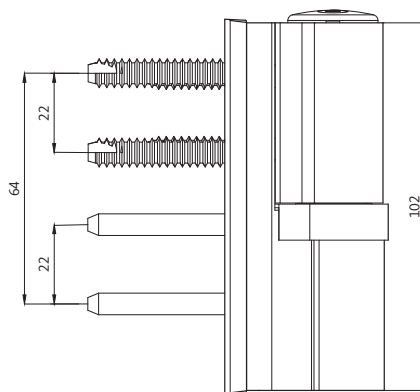
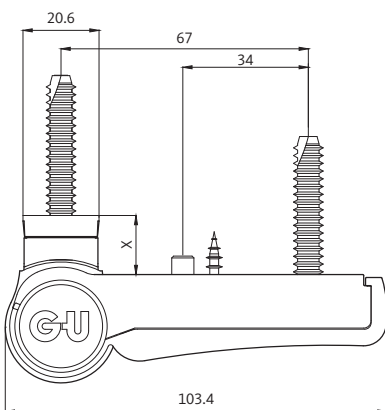

Adjustment options

- Horizontal adjustment: ± 4 mm
- Vertical adjustment: +4 mm / -1 mm
- Gasket pressure adjustment: -1 mm / +1.5 mm

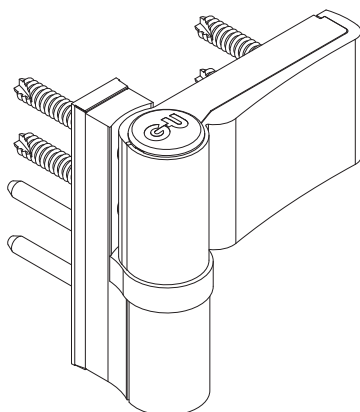

Overlap X in mm	Package size	Pack (unit)	Order number*
13.5 – 19.5	individual pack	1	H-01408-00-0-□
13.5 – 19.5	multi-pack	24	H-01408-24-0-□
17 – 23	individual pack	1	H-01409-00-0-□
17 – 23	multi-pack	24	H-01409-24-0-□
22 – 28	individual pack	1	H-01410-00-0-□
22 – 28	multi-pack	24	H-01410-24-0-□

Each pack contains: 1 hinge, 1 base plate, 2 insert plates, 1 set of screws, 1 cover cap, 1 rosette

Product-specific accessories	Pack (unit)	Order number
Security set for external installation	1	H-01484-00-0-1
Drilling jig	1	H-01407-00-0-0
Drilling jig holder, holds 3 of the drilling jigs referred to above	1	H-01467-00-0-0

Additional accessories

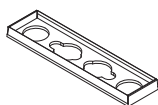

Description	Finish	Pack (unit)	Order number*
Base plate 1.5 mm high	black	1	H-01479-00-0-6
	white	1	H-01479-00-0-7

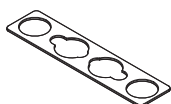

Description	Finish	Pack (unit)	Order number*
Insert plate 1 mm high	EV1 finish	1	H-01480-00-0-1

The number of insert plates required depends on which profile system is used, for more information refer to page 28.



Description	Finish	Pack (unit)	Order number*
Set of screws (4 Coniloc screws, 2 countersunk screws)	EV1 finish	1	H-01481-00-0-1



Description	Finish	Pack (unit)	Order number*
Cover	black	1	H-01482-00-0-6
	white	1	H-01482-00-0-7

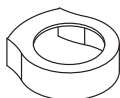

Description	Finish	Pack (unit)	Order number*
Rosette	black	1	H-01483-00-0-6
	white	1	H-01483-00-0-7

*Available finishes

Silver / EV1 finish = 1

Brown (RAL 8019) = 5

White (RAL 9016) = 7

More finishes available on request = 9

Surface

H-01408-00-0-□ = order number H-01408-00-0-7

GU G 812 F 100

For elements up to 120 kg, 100 mm leaf part



Product information

- Simple service-friendly one-man-installation
- 3D adjustment using only one tool, no need to unhinge or support the door leaf
- Simple installation requiring only 1 drill bit size
- Linear horizontal adjustment
- Non-corrosive security adjustment pin as standard

Materials

- Aluminium frame and leaf part
- Stainless steel pins
- Maintenance-free bearing system

Version

- Non-handed, exterior and interior use
- 100 mm leaf part

Overlaps

- 13.5 to 19.5 mm
- 17 to 23 mm
- 22 to 28 mm

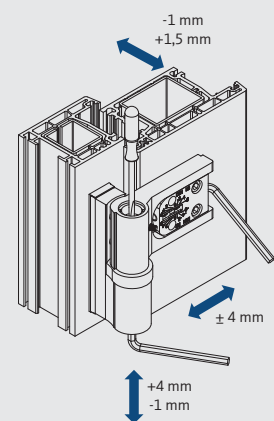
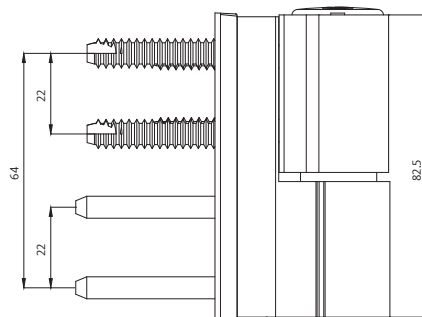
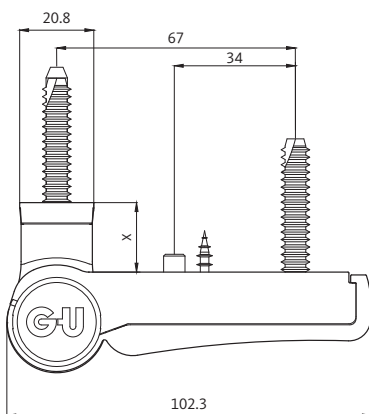

Adjustment options

- Horizontal adjustment: ± 4 mm
- Vertical adjustment: +4 mm / -1 mm
- Gasket pressure adjustment: -1 mm / +1.5 mm

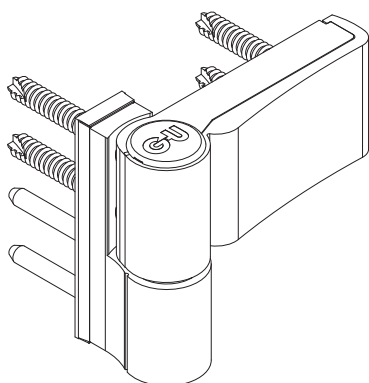

Overlap X in mm	Package size	Pack (unit)	Order number*
13.5 – 19.5	individual pack	1	H-01404-00-0-□
13.5 – 19.5	multi-pack	24	H-01404-24-0-□
17 – 23	individual pack	1	H-01405-00-0-□
17 – 23	multi-pack	24	H-01405-24-0-□
22 – 28	individual pack	1	H-01406-00-0-□
22 – 28	multi-pack	24	H-01406-24-0-□

Each pack contains: 1 hinge, 1 base plate, 2 insert plates, 1 set of screws, 1 cover

Product-specific accessories	Pack (unit)	Order number
Security set for external installation	1	H-01484-00-0-1
Drilling jig	1	H-01407-00-0-0
Drilling jig holder, holds 3 of the drilling jigs referred to above	1	H-01467-00-0-0

Additional accessories

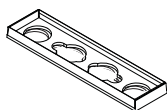

Description	Finish	Pack (unit)	Order number*
Base plate 1.5 mm high	black	1	H-01485-00-0-6
	white	1	H-01485-00-0-7

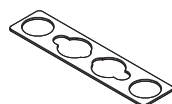

Description	Finish	Pack (unit)	Order number*
Insert plate 1 mm high	EV1 finish	1	H-01486-00-0-1
The number of insert plates required depends on which profile system is used, for more information refer to page 28.			



Description	Finish	Pack (unit)	Order number*
Set of screws (4 Coniloc screws, 2 countersunk screws)	EV1 finish	1	H-01481-00-0-1



Description	Finish	Pack (unit)	Order number*
Cover	black	1	H-01487-00-0-6
	white	1	H-01487-00-0-7

*Available finishes

Silver / EV1 finish = 1

Brown (RAL 8019) = 5

White (RAL 9016) = 7

More finishes available on request = 9

Surface

H-01404-00-0-□ = order number H-01404-00-0-7

GU G 810 F 100

For elements up to 100 kg, 100 mm leaf part



Product information

- Simple service-friendly one-man-installation
- 3D adjustment using only one tool, no need to unhinge or support the door leaf
- Simple installation requiring only 1 drill bit size
- Linear horizontal adjustment
- Non-corrosive security adjustment pin as standard

Materials

- Aluminium frame and leaf part
- Stainless steel pins
- Maintenance-free bearing system

Version

- Non-handed, exterior and interior use
- 100 mm leaf part

Overlaps

- 14 to 16.5 mm
- 16 to 22 mm

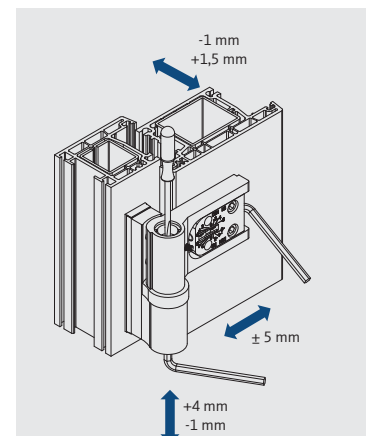
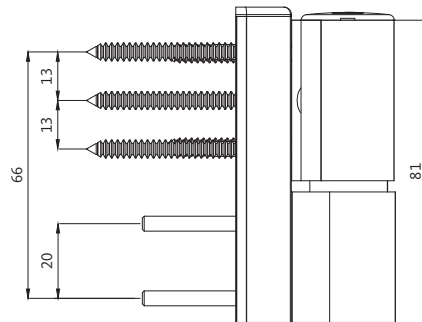
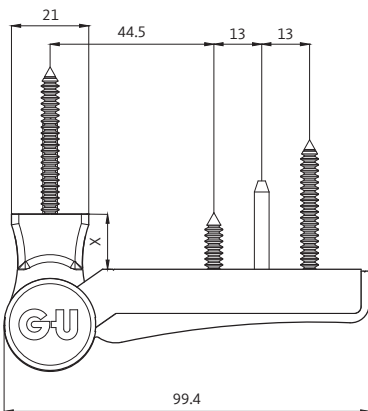

Adjustment options

- Horizontal adjustment: ± 5 mm
- Vertical adjustment: +4 mm / -1 mm
- Gasket pressure adjustment: -1 mm / +1.5 mm

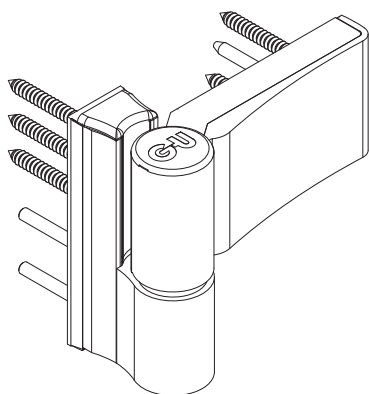

Overlap X in mm	Package size	Pack (unit)	Order number*
14 – 16.5	individual pack	1	H-01398-00-0-□
14 – 16.5	multi-pack	24	H-01398-24-0-□

Each pack contains: 1 hinge, 1 set of screws, 1 cover cap

Overlap X in mm	Package size	Pack (unit)	Order number*
16 – 22	individual pack	1	H-01399-00-0-□
16 – 22	multi-pack	24	H-01399-24-0-□

Each pack contains: 1 hinge, 1 base plate, 2 insert plates, 1 set of screws, 1 cover cap

Product-specific accessories	Pack (unit)	Order number
Drilling jig	1	H-01400-00-0-0
Drilling jig holder, holds 3 of the drilling jigs referred to above	1	H-01467-00-0-0

Additional accessories

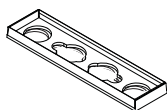

Description	Finish	Pack (unit)	Order number*
Base plate 1.5 mm high	black	1	H-01488-00-0-6
	white	1	H-01488-00-0-7

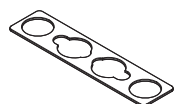

Description	Finish	Pack (unit)	Order number*
Insert plate 1 mm high	EV1 finish	1	H-01489-00-0-1
The number of insert plates required depends on which profile system is used, for more information refer to page 28.			



Description	Finish	Pack (unit)	Order number*
Cover	black	1	H-01487-00-0-6
	white	1	H-01487-00-0-7

*Available finishes

Silver / EV1 finish = 1

Brown (RAL 8019) = 5

White (RAL 9016) = 7

More finishes available on request = 9

Surface

H-01398-00-0-□ = order number H-01398-00-0-7

GU G 810 F 85

For elements up to 100 kg, 85 mm leaf part



Product information

- Simple service-friendly one-man-installation
- 3D adjustment using only one tool, no need to unhinge or support the door leaf
- Simple installation requiring only 1 drill bit size
- Linear horizontal adjustment
- Non-corrosive security adjustment pin as standard

Materials

- Aluminium frame and leaf part
- Stainless steel pins
- Maintenance-free bearing system

Version

- Non-handed, exterior and interior use
- 85 mm leaf part

Overlaps

- 14 to 16.5 mm
- 16 to 22 mm

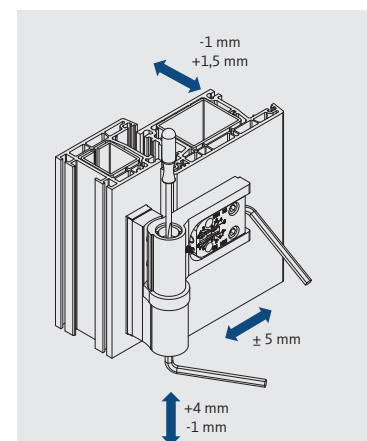
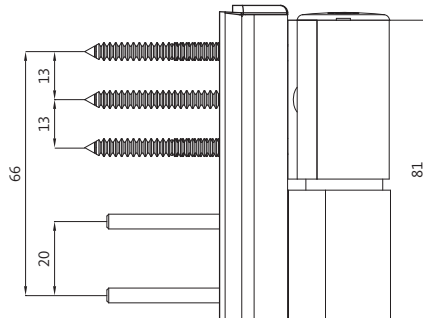
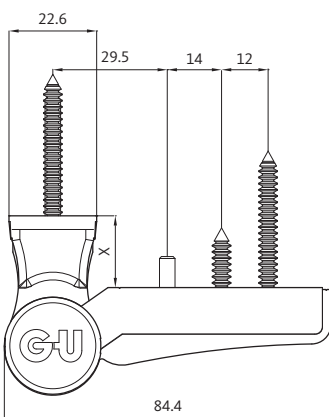

Adjustment options

- Horizontal adjustment: ± 5 mm
- Vertical adjustment: +4 mm / -1 mm
- Gasket pressure adjustment: -1 mm / +1.5 mm

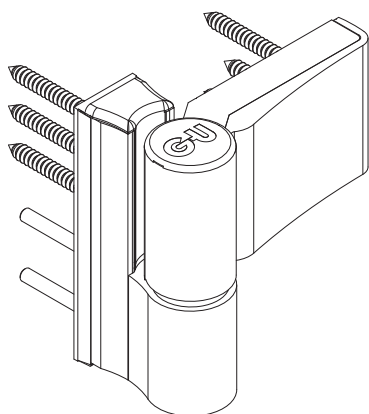

Overlap X in mm	Package size	Pack (unit)	Order number*
14 – 16.5	individual pack	1	H-01401-00-0-□
14 – 16.5	multi-pack	24	H-01401-24-0-□

Each pack contains: 1 hinge, 1 set of screws, 1 cover cap

Overlap X in mm	Package size	Pack (unit)	Order number*
16 – 22	individual pack	1	H-01402-00-0-□
16 – 22	multi-pack	24	H-01402-24-0-□

Each pack contains: 1 hinge, 1 base plate, 2 insert plates, 1 set of screws, 1 cover cap

Product-specific accessories	Pack (unit)	Order number
Drilling jig	1	H-01403-00-0-0
Drilling jig holder, holds 3 of the drilling jigs referred to above	1	H-01467-00-0-0

Additional accessories

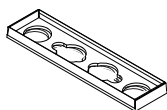

Description	Finish	Pack (unit)	Order number*
Base plate 1.5 mm high	black	1	H-01488-00-0-6
	white	1	H-01488-00-0-7

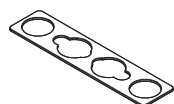

Description	Finish	Pack (unit)	Order number*
Insert plate 1 mm high	EV1 finish	1	H-01489-00-0-1
The number of insert plates required depends on which profile system is used, for more information refer to page 28.			



Description	Finish	Pack (unit)	Order number*
Cover	black	1	H-01487-00-0-6
	white	1	H-01487-00-0-7

*Available finishes

Silver / EV1 finish = 1

Brown (RAL 8019) = 5

White (RAL 9016) = 7

More finishes available on request = 9

Surface

H-01401-00-0-□ = order number H-01401-00-0-7

GU G 810 F 100 S

For elements up to 100 kg, 100 mm leaf part, narrow base plate



Product information

- Simple service-friendly one-man-installation
- 3D adjustment using only one tool, no need to unhinge or support the door leaf
- Simple installation requiring only 1 drill bit size
- Linear horizontal adjustment
- Non-corrosive security adjustment pin as standard

Materials

- Aluminium frame and leaf part
- Stainless steel pins
- Maintenance-free bearing system

Version

- Non-handed, exterior and interior use
- 100 mm leaf part

Overlaps

- 16 to 22 mm
- 19 to 25 mm

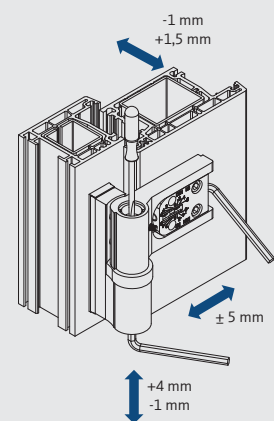
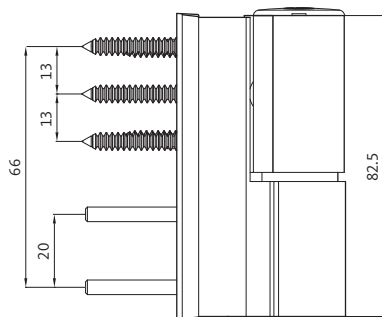
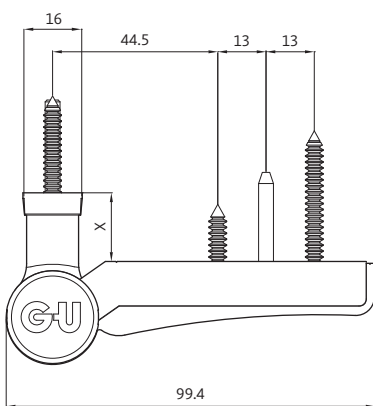

Adjustment options

- Horizontal adjustment: ± 5 mm
- Vertical adjustment: +4 mm / -1 mm
- Gasket pressure adjustment: -1 mm / +1.5 mm

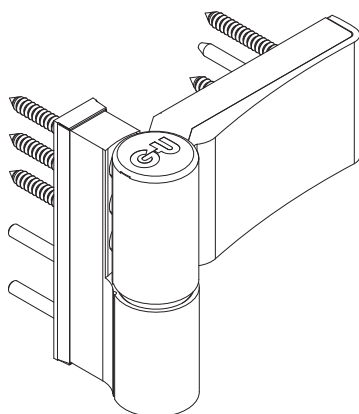

Overlap X in mm	Package size	Pack (unit)	Order number*
16 – 22	individual pack	1	H-01411-00-0-□
16 – 22	multi-pack	24	H-01411-24-0-□
19 – 25	individual pack	1	H-01520-00-0-□
19 – 25	multi-pack	24	H-01520-24-0-□

Each pack contains: 1 hinge, 1 base plate, 2 insert plates, 1 set of screws, 1 cover cap

Product-specific accessories	Pack (unit)	Order number
Drilling jig	1	H-01400-00-0-0
Drilling jig holder, holds 3 of the drilling jigs referred to above	1	H-01467-00-0-0

Additional accessories

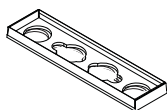

Description	Finish	Pack (unit)	Order number*
Base plate 1.5 mm high	black	1	H-01490-00-0-6
	white	1	H-01490-00-0-7

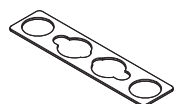

Description	Finish	Pack (unit)	Order number*
Insert plate 1 mm high	EV1 finish	1	H-01491-00-0-1
The number of insert plates required depends on which profile system is used, for more information refer to page 28.			



Description	Finish	Pack (unit)	Order number*
Cover	black	1	H-01487-00-0-6
	white	1	H-01487-00-0-7

*Available finishes

Silver / EV1 finish = 1

Brown (RAL 8019) = 5

White (RAL 9016) = 7

More finishes available on request = 9

Surface

H-01411-00-0-□ = order number H-01411-00-0-7

GU G 810 F 85 S

For elements up to 100 kg, 85 mm leaf part, narrow base plate



Product information

- Simple service-friendly one-man-installation
- 3D adjustment using only one tool, no need to unhinge or support the door leaf
- Simple installation requiring only 1 drill bit size
- Linear horizontal adjustment
- Non-corrosive security adjustment pin as standard

Materials

- Aluminium frame and leaf part
- Stainless steel pins
- Maintenance-free bearing system

Version

- Non-handed, exterior and interior use
- 85 mm leaf part

Overlaps

- 16 to 22 mm
- 19 to 25 mm

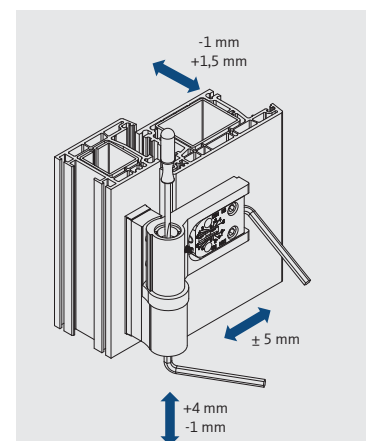
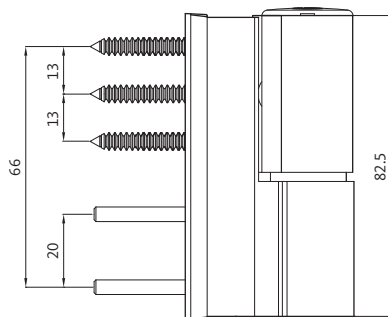
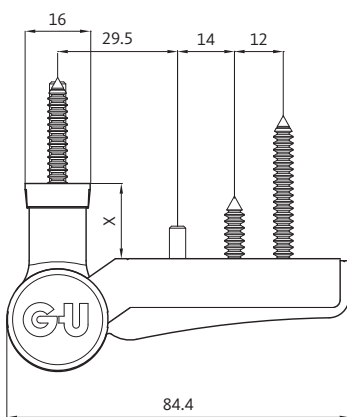

Adjustment options

- Horizontal adjustment: ± 5 mm
- Vertical adjustment: +4 mm / -1 mm
- Gasket pressure adjustment: -1 mm / +1.5 mm

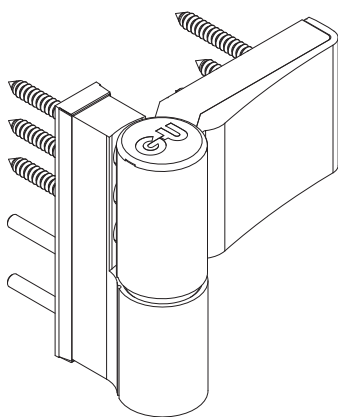

Overlap X in mm	Package size	Pack (unit)	Order number*
16 – 22	individual pack	1	H-01412-00-0-□
16 – 22	multi-pack	24	H-01412-24-0-□
19 – 25	individual pack	1	H-01519-00-0-□
19 – 25	multi-pack	24	H-01519-24-0-□

Each pack contains: 1 hinge, 1 base plate, 2 insert plates, 1 set of screws, 1 cover cap

Product-specific accessories	Pack (unit)	Order number
Drilling jig	1	H-01403-00-0-0
Drilling jig holder, holds 3 of the drilling jigs referred to above	1	H-01467-00-0-0

Additional accessories

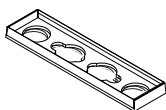

Description	Finish	Pack (unit)	Order number*
Base plate 1.5 mm high	black	1	H-01490-00-0-6
	white	1	H-01490-00-0-7

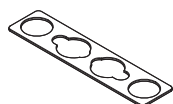

Description	Finish	Pack (unit)	Order number*
Insert plate 1 mm high	EV1 finish	1	H-01491-00-0-1
The number of insert plates required depends on which profile system is used, for more information refer to page 28.			



Description	Finish	Pack (unit)	Order number*
Cover	black	1	H-01487-00-0-6
	white	1	H-01487-00-0-7

*Available finishes

Silver / EV1 finish = 1

Brown (RAL 8019) = 5

White (RAL 9016) = 7

More finishes available on request = 9

Surface

H-01412-00-0-□ = order number H-01412-00-0-7

GU F 110

For elements of up to 100 kg, leaf part 110 mm



Product information

- Simple service-friendly one-man-installation
- 3D adjustment using only one tool, no need to unhinge or support the door leaf
- Simple installation requiring only 1 drill bit size
- Linear horizontal adjustment

Materials

- Stainless steel pins
- Maintenance-free bearing system

Version

- DIN LH / DIN RH
- 110 mm leaf part

Overlaps

- 12.5 to 16 mm
- 16 to 19.5 mm
- 19.5 to 22
- 22 to 25.5 mm

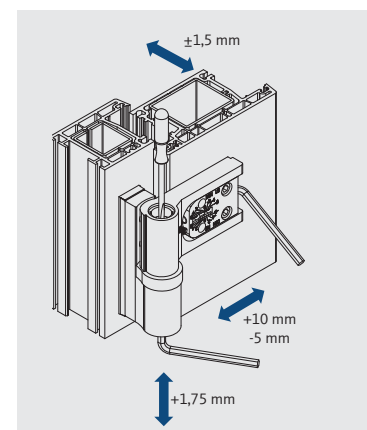
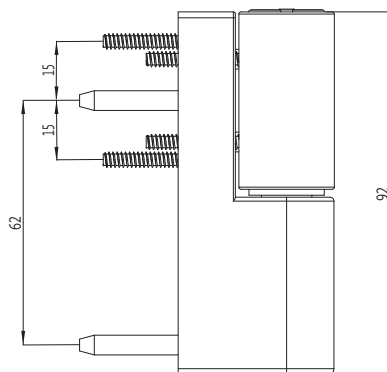
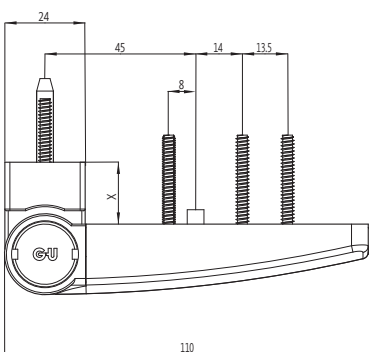

Adjustment options

- Horizontal adjustment: +10 mm / -5 mm
- Vertical adjustment: +1.75 mm
- Gasket pressure adjustment: ±1.5 mm

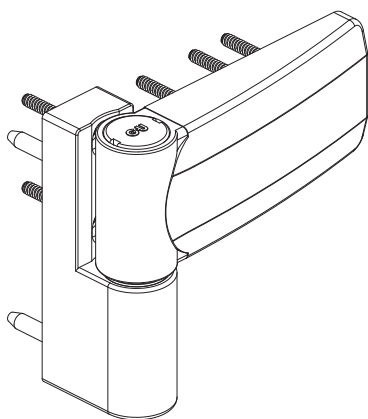

Overlap X in mm	Package size	Pack (unit)	Order number*
12.5 – 16	individual pack	50	H-01337-11-0-□
12.5 – 16	multi-pack	24	H-01341-11-0-□
16 – 19.5	individual pack	50	H-01338-11-0-□
16 – 19.5	multi-pack	24	H-01342-11-0-□
19.5 – 22	individual pack	50	H-01339-11-0-□
19.5 – 22	multi-pack	24	H-01343-11-0-□
22 – 25.5	individual pack	50	H-01340-11-0-□
22 – 25.5	multi-pack	24	H-01344-11-0-□

Each pack contains: 1 hinge, 1 set of screws, 1 cover cap, 1 small cover cap

Product-specific accessories	Pack (unit)	Order number
Drilling jig	1	H-00311-00-0-0

Additional accessories



Description	Finish	Pack (unit)	Order number*
Cover	black	50	H-01345-00-0-6
	white	50	H-01345-00-0-7
Cover, small	black	50	H-01346-00-0-6
	white	50	H-01346-00-0-7

*Available finishes

Silver / EV1 finish = 1

Brown (RAL 8019) = 5

White (RAL 9016) = 7

More finishes available on request = 9

Surface

H-01337-11-0-□ = order number H-01337-11-0-7

GU F 90

For elements up to 80 kg, 90 mm leaf part



Product information

- Simple service-friendly one-man-installation
- 3D adjustment using only one tool, no need to unhinge or support the door leaf
- Simple installation requiring only 1 drill bit size
- Linear horizontal adjustment

Materials

- Stainless steel pins
- Maintenance-free bearing system

Version

- DIN LH / DIN RH
- 90 mm leaf part

Overlaps

- 12.5 to 16 mm
- 16 to 19.5 mm
- 19.5 to 22 mm
- 22 to 25.5 mm

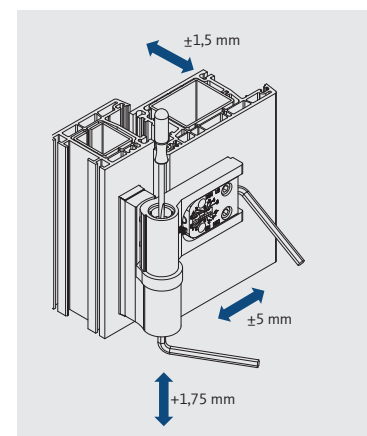
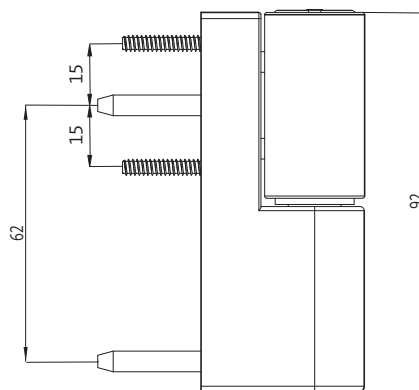
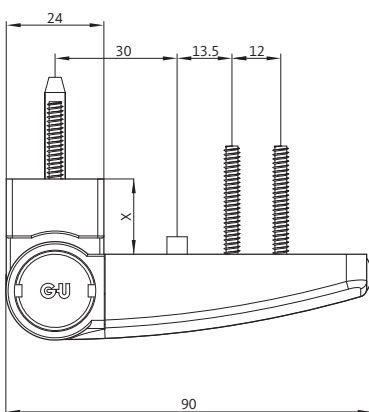

Adjustment options

- Horizontal adjustment: ± 5 mm
- Vertical adjustment: $+1.75$ mm
- Gasket pressure adjustment: ± 1.5 mm

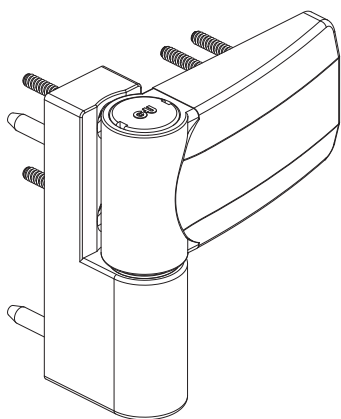

Overlap X in mm	Package size	Pack (unit)	Order number*
12.5 – 16	individual pack	50	H-01337-09-0-□
12.5 – 16	multi-pack	24	H-01341-09-0-□
16 – 19.5	individual pack	50	H-01338-09-0-□
16 – 19.5	multi-pack	24	H-01342-09-0-□
19.5 – 22	individual pack	50	H-01339-09-0-□
19.5 – 22	multi-pack	24	H-01343-09-0-□
22 – 25.5	individual pack	50	H-01340-09-0-□
22 – 25.5	multi-pack	24	H-01344-09-0-□

Each pack contains: 1 hinge, 1 set of screws, 1 cover cap, 1 small cover cap

Product-specific accessories	Pack (unit)	Order number
Drilling jig	1	H-00311-00-0-0

Additional accessories



Description	Finish	Pack (unit)	Order number*
Cover	black	50	H-01345-00-0-6
	white	50	H-01345-00-0-7
Cover, small	black	50	H-01346-00-0-6
	white	50	H-01346-00-0-7

*Available finishes

Silver / EV1 finish = 1

Brown (RAL 8019) = 5

White (RAL 9016) = 7

More finishes available on request = 9

Surface

H-01337-09-0-□ = order number H-01337-09-0-7

Profile-specific application recommendations

Insert plates and base plates



	Overlap height of profile in mm	For the hinge systems GU G 812 and GU G 816			For the hinge systems GU G 810 F 100 and GU G 810 F 85			For the hinge systems GU G 810 F 100 S and GU G 810 F 85 S		
		Hinge with overlap X in mm	Insert plates required	Base plates required	Hinge with overlap X in mm	Insert plates required	Base plates required	Hinge with overlap X in mm	Insert plates required	Base plates required
Alphacan										
Alphacan	24	22 – 28	0	1	-	-	-	19 – 25	2	1
Aluplast										
Aluplast Ideal 2000	16.5	13.5 – 19.5	0	1	14 – 16.5 or 16 – 22	0	0	16 – 22	0	0
Aluplast Ideal 4000	19	13.5 – 19.5 or 17 – 23	2 0	1 1	16 – 22	0	1	16 – 22 or 19-25	1 0	1 0
Aluplast Ideal 5000	19	13.5 – 19.5 or 17 – 23	2 0	1 1	16 – 22	0	1	16 – 22 or 19 – 25	1 0	1 0
Aluplast Ideal 6000	19	13.5 – 19.5 or 17 – 23	2 0	1 1	16 – 22	0	1	16 – 22 or 19 – 25	1 0	1 0
Aluplast Ideal 7000	19	13.5 – 19.5 or 17 – 23	2 0	1 1	16 – 22	0	1	16 – 22 or 19 – 25	1 0	1 0
Aluplast Ideal 8000	24	22 – 28	0	1	-	-	-	19 – 25	2	1
Brüggmann										
Brüggmann	18.5	13.5 – 19.5 or 17 – 23	2 0	1 0	16 – 22	0	1	16 – 22	0	1
Brüggmann AD	16.5	13.5 – 19.5	0	1	14 – 16.5 or 16 – 22	0	0	16 – 22	0	0
Brüggmann Euro 92	15	13.5 – 19.5	0	0	14 – 16.5	0	0	-	-	-
Deceuninck										
Deceuninck 2000	18	13.5 – 19.5 or 17 – 23	2 0	1 0	16 – 22	0	0	16 – 22	0	1
Deceuninck 3000	19	13.5 – 19.5 or 17 – 23	2 0	1 1	16 – 22	0	1	16 – 22 or 19 – 25	1 0	1 0
Exte										
Exte	18	13.5 – 19.5 or 17 – 23	2 0	1 0	16 – 22	0	0	16 – 22	0	1
Finstral										
Finstral	17	13.5 – 19.5 or 17 – 23	1 0	1 0	16 – 22	0	0	16 – 22	0	0

	Overlap height of profile in mm	For the hinge systems GU G 812 and GU G 816			For the hinge systems GU G 810 F 100 and GU G 810 F 85			For the hinge systems GU G 810 F 100 S and GU G 810 F 85 S		
		Hinge with overlap X in mm	Insert plates required	Base plates required	Hinge with overlap X in mm	Insert plates required	Base plates required	Hinge with overlap X in mm	Insert plates required	Base plates required
Gealan										
Gealan S 3000	16.5	13.5 – 19.5	0	1	14 – 16.5 or 16 – 22	0	0	16 – 22	0	0
Gealan S 7000 IQ	16.5	13.5 – 19.5	0	1	14 – 16.5 or 16 – 22	0	0	16 – 22	0	0
Gealan S 7000 IQ plus	24	22 – 28	0	0	-	-	-	19 – 25	2	1
Gealan S 8000 IQ	16.5	13.5 – 19.5	0	1	14 – 16.5 or 16 – 22	0	0	16 – 22	0	0
Gealan S 8000 IQ plus	24	22 – 28	0	0	-	-	-	19 – 25	2	1
INOUSIC										
Inoutic Arcade / Elite 71	20	17 – 23	0	1	16 – 22	1	1	16 – 22 or 19 – 25	1 0	1 0
Inoutic Prestige	24	22 – 28	0	0	-	-	-	19 – 25	2	1
Inoutic Eforte	20.5	17 – 23	1	1	16 – 22	2	1	16 – 22 or 19 – 25	2 0	1 0
KBE										
KBE 58AD	16.5	13.5 – 19.5	0	1	14 – 16.5 or 16 – 22	0	0	16 – 22	0	0
KBE 70 AD / MD	20.5	17 – 23	1	1	16 – 22	2	1	16 – 22 or 19 – 25	2 0	1 0
KBE 88 AD / MD	24	22 – 28	0	0	-	-	-	19 – 25	2	1
Kömmerring										
Kömmerring Euro Futur Classic	19.5	13.5 – 19.5	2	1	16 – 22	1	1	16 – 22	1	1
		or 17 – 23	0	1				or 19 – 25	0	0
Kömmerring Euro Elegance	19.5	13.5 – 19.5	2	1	16 – 22	1	1	16 – 22	1	1
		or 17 – 23	0	1				or 19 – 25	0	0
Kömmerring Euro Futur MD Classic	19.5	13.5 – 19.5	2	1	16 – 22	1	1	16 – 22	1	1
		or 17 – 23	0	1				or 19 – 25	0	0
Kömmerring Euro Futur MD Exklusiv	19.5	13.5 – 19.5	2	1	16 – 22	1	1	16 – 22	1	1
		or 17 – 23	0	1				or 19 – 25	0	0
Kömmerring Alu Fusion 70 mm	21	17 – 23	1	1	16 – 22	2	1	16 – 22	2	1
								or 19 – 25	0	1
Kömmerring K-vision	20	17 – 23	0	1	16 – 22	1	1	16 – 22	1	1
								or 19 – 25	0	0
Kömmerring 88 +	24	22 – 28	0	0	-	-	-	19 – 25	2	1
Kömmerring Alu Fusion 88 mm	23	17 – 23	2	1	-	-	-	19 – 25	2	1
		or 22 – 28	0	0						

Profile-specific application recommendations

Insert plates and base plates



	Overlap height of profile in mm	For the hinge systems GU G 812 and GU G 816			For the hinge systems GU G 810 F 100 and GU G 810 F 85			For the hinge systems GU G 810 F 100 S and GU G 810 F 85 S		
		Hinge with overlap X in mm	Insert plates required	Base plates required	Hinge with overlap X in mm	Insert plates required	Base plates required	Hinge with overlap X in mm	Insert plates required	Base plates required
LB										
LB Profile PAD	16.5	13.5 – 19.5	0	1	14 – 16.5 or 16 – 22	0	0	16 – 22	0	0
Osmopane										
Osmopane	17	13.5 – 19.5 or 17 – 23	1 0	1 0	16 – 22	0	0	16 – 22	0	0
Plusplan										
Plusplan 3K-System AD	15	13.5 – 19.5	0	0	14 – 16.5	0	0	-	-	-
Pural										
Pural	15	13.5 – 19.5	0	0	14 – 16.5	0	0	-	-	-
Rehau										
Rehau Euro design 60	17	13.5 – 19.5 or 17 – 23	1 0	1 0	16 – 22	0	0	16 – 22	0	0
Rehau Brillant / Euro Design 70 AD	19	13.5 – 19.5 or 17 – 23	2 0	1 1	16 – 22	0	1	16 – 22 or 19 – 25	1 0	1 0
Rehau Brillant 70 MD	19	13.5 – 19.5 or 17 – 23	2 0	1 1	16 – 22	0	1	16 – 22 or 19 – 25	1 0	1 0
Rehau Charcter Design 70	19	13.5 – 19.5 or 17 – 23	2 0	1 1	16 – 22	0	1	16 – 22 or 19 – 25	1 0	1 0
Rehau Geneo	25	22 – 28	0	1	-	-	-	19 – 25	2	1
Rehau Euro Design 86 Plus	25	22 – 28	0	1	-	-	-	19 – 25	2	1
Roplasto										
Roplasto	16	13.5 – 19.5	0	1	14 – 16.5 or 16 – 22	0 0	0 0	16 – 22	0	0
Roplasto 4K	16	13.5 – 19.5	0	1	14 – 16.5 or 16 – 22	0 0	0 0	16 – 22	0	0
Roplasto 4K Plus	16	13.5 – 19.5	0	1	14 – 16.5 or 16 – 22	0 0	0 0	16 – 22	0	0

	Overlap height of profile in mm	For the hinge systems GU G 812 and GU G 816			For the hinge systems GU G 810 F 100 and GU G 810 F 85			For the hinge systems GU G 810 F 100 S and GU G 810 F 85 S		
		Hinge with overlap X in mm	Insert plates required	Base plates required	Hinge with overlap X in mm	Insert plates required	Base plates required	Hinge with overlap X in mm	Insert plates required	Base plates required
Salamander										
Salamander Design 2 D	17.5	13.5 – 19.5 or 17 – 23	1 0	1 0	16 – 22	0	0	16 – 22	0	0
Salamander Design 3 D	17.5	13.5 – 19.5 or 17 – 23	1 0	1 0	16 – 22	0	0	16 – 22	0	0
Salamander Streamline	17.5	13.5 – 19.5 or 17 – 23	1 0	1 0	16 – 22	0	0	16 – 22	0	0
Salamander Blue Evolution	22	17 – 23 or 22 – 28	2 0	1 0	16 – 22	2	1	16 – 22 or 19 – 25	2 0	1 1
Schüco										
Schüco Corona AS 60	16	13.5 – 19.5	0	1	14 – 16.5 or 16 – 22	0 0	0 0	16 – 22	0	0
Schüco Corona CT70 AS / MD / Accent	20	17 – 23	0	1	16 – 22	1	1	16 – 22 or 19 – 25	1 0	1 0
Schüco Corona SI 82 / SI 82+	20	17 – 23	0	1	16 – 22	1	1	16 – 22 or 19 – 25	1 0	1 0
Trocal										
Trocal InnoNova 70.M5 / 2000	17.5	13.5 – 19.5 or 17 – 23	1 0	1 0	16 – 22	0	0	16 – 22	0	0
Trocal InnoNova 70.A5	21	17 – 23	1	1	16 – 22	2	1	16 – 22 or 19 – 25	2 0	1 1
Trocal Alu Fusion MD 70	17.5	13.5 – 19.5 or 17 – 23	1 0	1 0	16 – 22	0	0	16 – 22	0	0
Trocal 88 +	24	22 – 28	0	0	-	-	-	19 – 25	2	1
Trocal Alu Fusion 88+ MD	24	22 – 28	0	0	-	-	-	19 – 25	2	1
VEKA										
VEKA Softline AD	19	13.5 – 19.5 or 17 – 23	2 0	1 1	16 – 22	0	1	16 – 22 or 19 – 25	1 0	1 0
VEKA Softline MD	19	13.5 – 19.5 or 17 – 23	2 0	1 1	16 – 22	0	1	16 – 22 or 19 – 25	1 0	1 0
VEKA Topline AD	19	13.5 – 19.5 or 17 – 23	2 0	1 1	16 – 22	0	1	16 – 22 or 19 – 25	1 0	1 0
VEKA Alphaline MD	25	22 – 28	0	1	-	-	-	19 – 25	2	1
VEKA Softline 82 AD / MD	19	13.5 – 19.5 or 17 – 23	2 0	1 1	16 – 22	0	1	16 – 22 or 19 – 25	1 0	1 0

Options for 3D adjustment of hinges



Gasket pressure adjustment

The hinge can be perfectly adjusted using the gasket pressure adjustment.

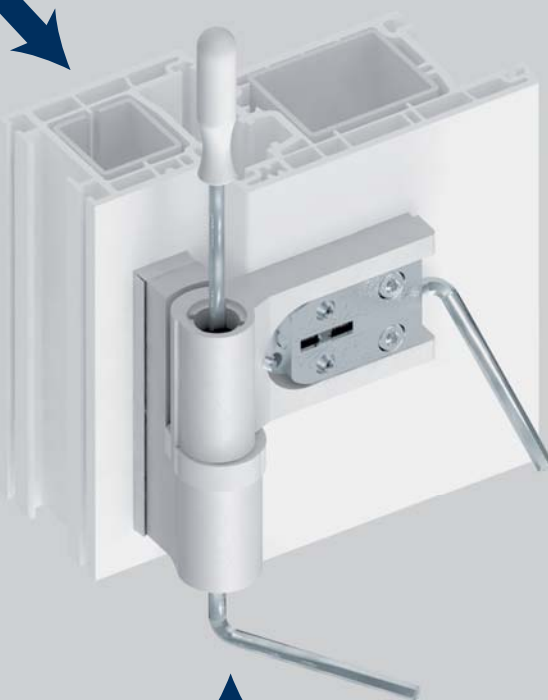

Horizontal adjustment

The door leaf can be adjusted steplessly in the horizontal direction via the self-locking screw, also without detaching the hinge components.



Vertical adjustment

The vertical height of the leaf can be adjusted with only a few turns, also when the door is hung.



Adjustment options according to hinge version:

	For hinge systems G 812 and GU G 816	For hinge system G 810	For hinge system GU F 90	For hinge system GU F 110
Gasket pressure adjustment	+1.50 mm / -1.00 mm	+1.50 mm / -1.00 mm	+1.50 mm / -1.50 mm	+1.50 mm / -1.50 mm
Horizontal adjustment	+4.00 mm / -4.00 mm	+5.00 mm / -5.00 mm	+5.00 mm / -5.00 mm	+10.00 mm / -5.00 mm
Vertical adjustment	+4.00 mm / -1.00 mm	+4.00 mm / -1.00 mm	+1.75 mm	+1.75 mm



Exclusion of liability

The information provided in this catalogue consists of product descriptions. They represent general information based on our experience and tests and do not take account of the specific instance of application. No claims for compensation can be made on the basis of the product descriptions.

The information given here is provided to the best of our knowledge, but is non-binding. It should be adapted to the respective building, usage and specific local stress conditions.

Copyright protection

© Please note that the drawings and pictures are protected by copyright. The catalogue has been compiled to the best of our knowledge. Gretsche-Unitas Group accepts no liability for any mistakes. Changes are possible within the framework of technical progress.

The product images shown in the catalogue may differ from the actual product.

The GU-Group Worldwide

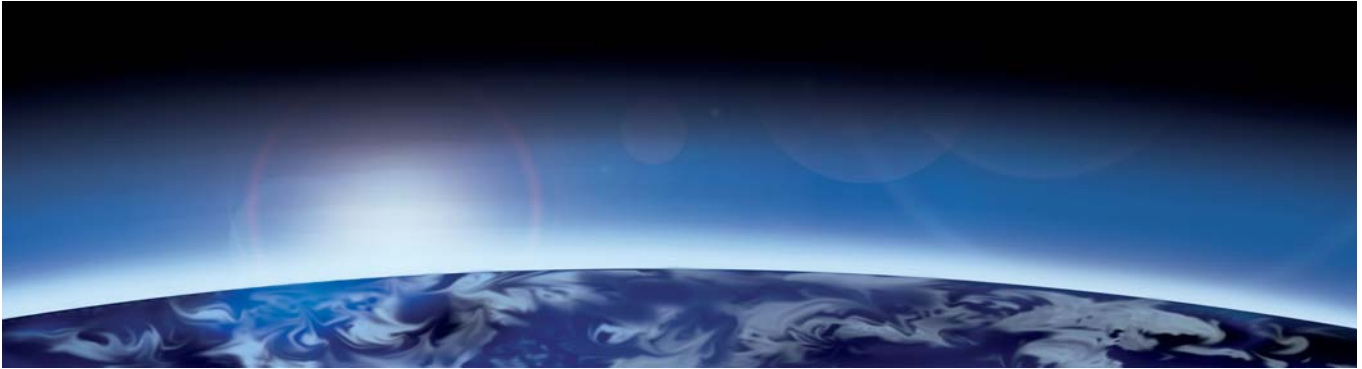

Production

Germany:

Gretsch-Unitas GmbH
Baubeschläge

BKS GmbH

GU Automatic GmbH

ela-soft GmbH

France:

FERCO International
S.A.S.

Slovakia:

GU Slovensko S.R.O.

Canada:

FERRIC HARDWARE Inc.

Sales

Albania

Argentina

Australia

Austria

Azerbaijan

Bahrain

Belgium

Bosnia-Herzegovina

Brazil

Bulgaria

Canada

Chile

China

Croatia

Cyprus

Czech Republic

Denmark

Egypt

Estonia

Germany

Greece

Hungary

Finland

France

India

Indonesia

Iran

Ireland

Israel

Italy

Japan

Kazakhstan

Kuwait

Latvia

Lithuania

Macedonia

Malaysia

Mexico

Moldova

Morocco

New Zealand

Norway

Oman

Poland

Portugal

Qatar

Romania

Russia

Saudi Arabia

Serbia

Slovakia

South Korea

Spain

Sweden

Switzerland

Thailand

The Netherlands

Turkey

Ukraine

United Arab Emirates

United Kingdom

USA

Vietnam



Quality: GU and BKS successfully certified

EN ISO 9001:2008 defines a company's structural, operational and quality management requirements.

In 1995, the AGQS e.V. accreditation association certified Gretsch-Unitas GmbH Baubeschläge's successful implementation of a quality control system in compliance with EN ISO 9001:2008.

The manufacturing of high-quality hardware is of constant concern for GU. The certification programme also confirms that the internal company processes – from development right through to sales and customer service – coincide with this concern.





WINDOW TECHNOLOGY
DOOR TECHNOLOGY
AUTOMATIC ENTRANCE SYSTEMS
BUILDING MANAGEMENT SYSTEMS

Gretsch-Unitas GmbH
Baubeschlage
Johann-Maus-Str. 3
D-71254 Ditzingen
Tel. + 49 (0) 71 56 3 01-0
Fax + 49 (0) 71 56 3 01-77980

BKS GmbH
Heidestr. 71
D-42549 Velbert
Tel. + 49 (0) 20 51 2 01-0
Fax + 49 (0) 20 51 2 01-9733

www.g-u.com

Securing technology for you

